

LD 5500/7500

instructions



4270 Airborn Drive
Addison, TX 75001, USA
Toll Free 800.259.1986
Tel 972.248.1999
Fax 972.248.1991
info@startinternational.com
www.startinternational.com

1-26-14 Toshin-Cho
Itabashi-ku
Tokyo, Japan
Tel 81.3.3554.5608
Fax 81.3.5966.9591
japan@startinternational.com



CONTENTS

Read this user's manual before use to ensure proper operation. Keep the manual on hand for reference in case there is a problem.

- Warranty Information2
- Features3
- Notes3
- Repair Policy3
- Specifications3
- Set-up4
- Operation/Adjustments5
- Maintenance6
- Legend6
- Exploded View7

WARRANTY POLICY FOR LD SERIES LABEL DISPENSERS

Start International warrants all parts on LD series label dispensers against defects in design, materials and workmanship for a period of 360 days. Labor to replace defective parts will be performed at no charge for the first 180 days after date of purchase. Warranty does not cover transportation costs.

Our sole obligation under this warranty is limited to repair, replacement or credit of the purchase price, at our option, for the machines listed above, which do not perform properly the function for which they were designed.

Warranty repair is contingent upon our examination and determination that alleged defects have not been caused by misuse, abuse, improper installation or application, repair, alteration, accident or neglect in use, storage, transportation or handling.

The above warranty and remedy constitutes Start International's sole liability hereunder and are in lieu and exclusive of all other warranties and remedies expressed, implied, or statutory, including, but not limited to, those of merchantability and fitness for a particular purpose.

EXPLODED VIEW

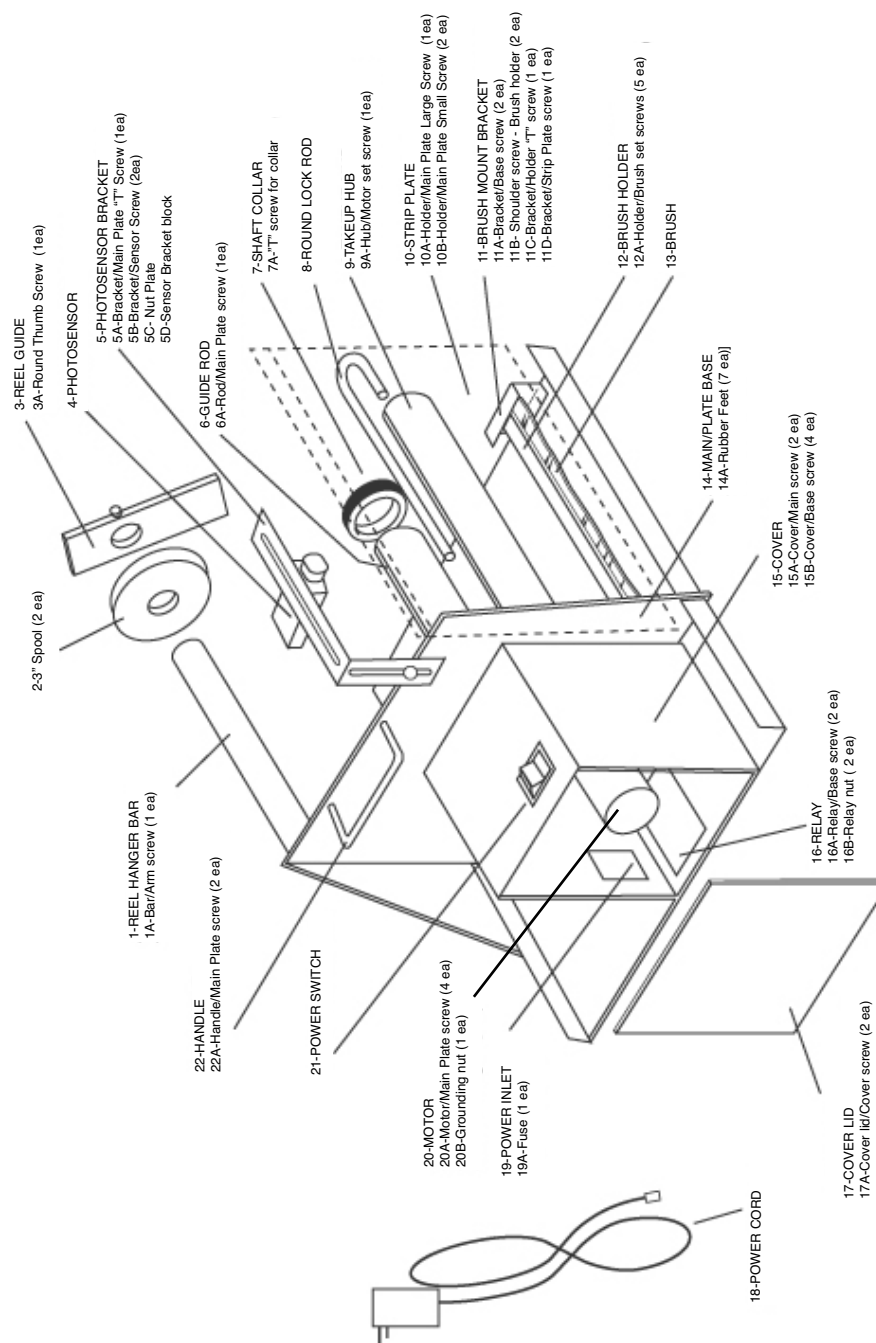

NOTE: Drawing not to scale - for reference only

SET-UP INSTRUCTIONS

Place the label roll on the 1" (25mm) reel hanger bar.

If roll has 3" (76.2mm) core, use plastic spool

Slide Material Guide onto reel hanger bar to hold roll against reel holder arm to ensure it is held straight.

(Material Guide and spool included.)

Thread the liner under the guide rod, between the hold down brush and the strip plate, then back over the strip plate. Lay the liner across the slot in the take-up hub. Slide the lock rod into the slot to secure the liner. Align shaft collar on guide rod with edge of liner to keep material feeding straight.

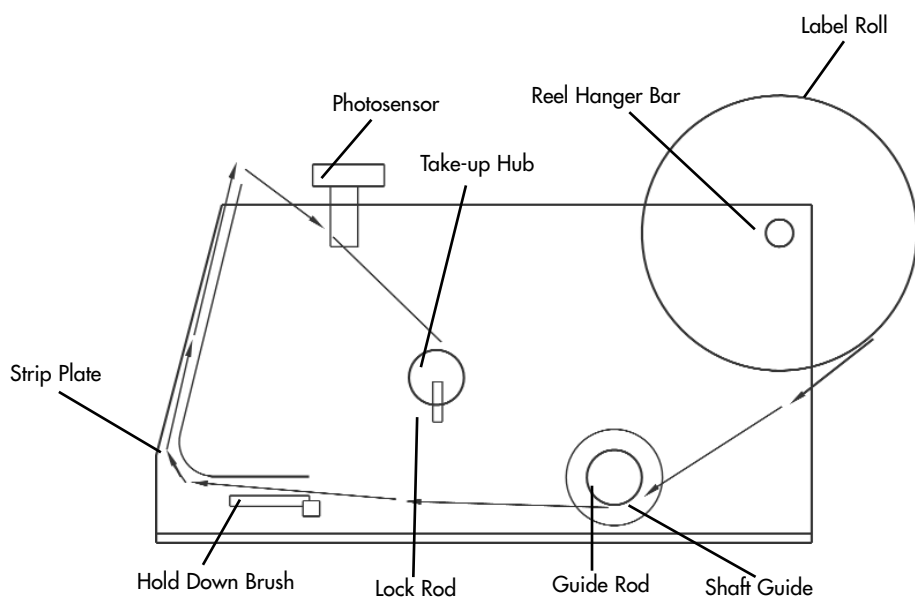

ADJUSTMENTS

Hold Down Brush:

Using the thumbscrew on the Brush Mount Bracket, adjust the hold down brush for tensioning.

For best results, labels should be pressed firmly against the strip plate. If labels are held too tightly, they will cause excessive drag on the motor.

Photosensor:

The photosensor can be adjusted in any direction to accommodate virtually any label. Loosening the "T" thumbscrew allows the photosensor to swivel and sets the overhang distance of the label over the strip plate. When the label is being fed the correct distance, tighten the "T" thumbscrew.

Loosen the two screws on the top of the sensor holder to align the photosensor with the center of the label. If there are two or more labels across, align the photosensor with the last label to be removed. When these two screws are tightened, the machine is set.

Positioning of Photosensor

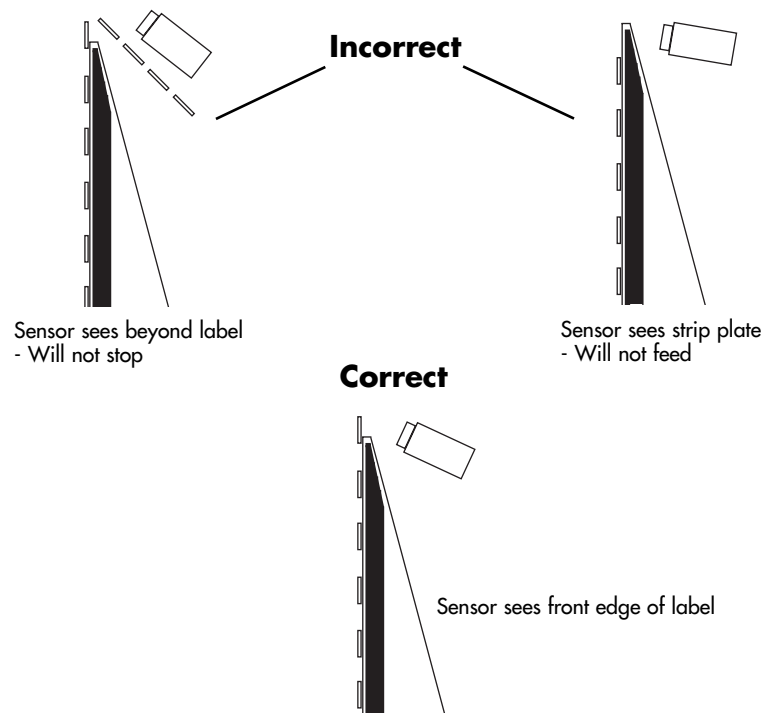

MAINTENANCE

Turn machine off when not in use. Remove liner material from take-up hub at approximately 3" in diameter or if motor appears to be straining. Do not operate machine without covers in place. Do not operate if inspection reveals a damaged power or sensor cord.

LEGEND		
	Model LD5500	Model LD7500
Item #	Part #	
1	LD5500-26	LD7500-26
1A	LD50017-1	LD50017-1
2	LD-SPOOL	LD-SPOOL
3	LD50023A	LD50023A
3A	LD50023-2	LD50023-2
4	LD50002A	LD50002A
5	LD7500-07	LD7500-07
5A	LD50011-2A	LD50011-2A
5B	LD50011-1	LD50011-1
5C	LD50011A	LD50011A
5D	LD7500-07-1	LD7500-07-1
6	LD5500-08	LD7500-08
6A	LD7500-08-1	LD7500-08-1
7	LD7500-08-2	LD7500-08-2
7A	LD7500-08-3	LD7500-08-3
8	LD5500-27	LD7500-27
9	LD5500-05	LD7500-05
9A	LD50012-1	LD50012-1
10	LD5500-04B	LD7500-04B
10A	LD7500-08-1	LD7500-08-1
10B	LD7500-11-1	LD7500-11-1
11	LD7500-22	LD7500-22
11A	LD7500-11-3	LD7500-11-3
11B	LD7500-23-1	LD7500-23-1
11C	LD50011-2A	LD50011-2A
11D	LD7500-11-1	LD7500-11-1
12	LD5500-23	LD7500-23
12A	LD50026-1	LD50026-1
13	LD50026A	LD70026A
14	LD5500-25	LD7500-25
14A	LD50024	LD50024
15	LD7500-11	LD7500-11
15A	LD7500-11-1	LD7500-11-1
15B	LD7500-11-3	LD7500-11-3
16	LD50021S	LD50021S
16A	LD50005-1	LD50005-1
16B	LD50021-1	LD50021-1
17	LD7500-12	LD7500-12
17A	LD50008-1	LD50008-1
18	LD50018C	LD50018C
19	LD50019	LD50019
19A	LD50019F	LD50019F
20	LD50001B2	LD50001B2
20A	LD50001-1	LD50001-1
20B	LD50018-2	LD50018-2
21	LD50003	LD50003
22	LD7500-13	LD7500-13
22A	LD7500-11-1	LD7500-11-1

FEATURES

- Will dispense butt-cut and die-cut material.
- Adjustable photosensor for pinpoint accuracy.
- Handled lock rod makes scrap removal easy.
- No tools required for adjustment.

NOTES

- Keep strip plate free of adhesive build-up.
- Clean photosensor with compressed air or dry cloth.
- Do not drop the dispenser or subject it to heavy shock.
- Turn off machine when not in use.

REPAIR POLICY

Contact START INTERNATIONAL to determine nature of problem.

Furnish START with the following information:

1. Who the unit was purchased from.
2. Model number and serial number.
3. Date purchased (copy of invoice or packing slip required).

START will issue an RGA (Return Goods Authorization) for repair.

Return machine to START by UPS, insured and prepaid.

START will notify the customer if there is a repair charge.

SPECIFICATIONS:

Model#	LD5500	LD7500
Liner Capacity	.25" to 5" (6.35mm to 127mm)	.25" to 8" (6.35mm to 203.2mm)
Width		
Label Length	.5" to 12" (12.7mm to 305mm)	.5" to 12" (12.7mm to 305mm)
Roll Capacity	12" (30.5cm)	12" (30.5cm)
*Feed Speed	3.9" / sec. (9.56cm / sec.)	3.9" / sec. (9.56cm / sec.)
Dimensions Inches	14.5(L) x 12.5(W) x 11.0(H)	14.5(L) x 15.5(W) x 11.0(H)
Centimeters	363(L) x 318(W) x 279(H)	363(L) x 394(W) x 279(H)
Weight	24.5lb. (11.1kg.)	28lb. (12.7kg.)
Electrical Requirements	117V 50/60Hz, <1 amp (220V 50/60Hz available)	117V 50/60Hz, <1 amp (220V 50/60Hz available)

*at start-up